

DATA SHEET

U 5.71 O₂-PACK ROTARY VANE VACUUM PUMPS

oil-lubricated and air-cooled
for MAP applications with O₂ > 20.9%

MAKE IT BECKER.

SMOOTH SURFACES

for quick, easy and
hygienic cleaning

**FASTEST
PUMP-DOWN TIME**

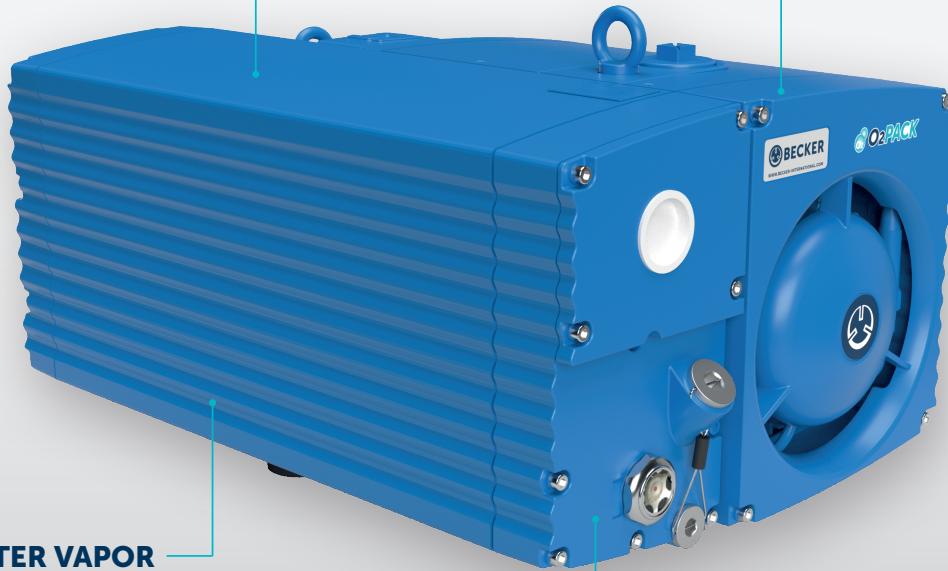

**HIGH WATER VAPOR
TOLERANCE**

ENLARGED OIL TANK



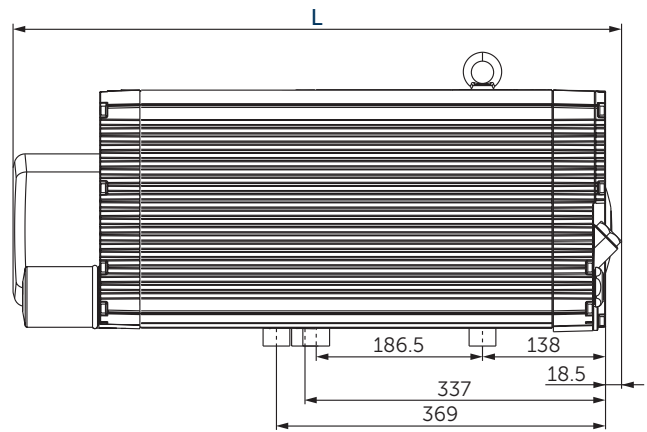
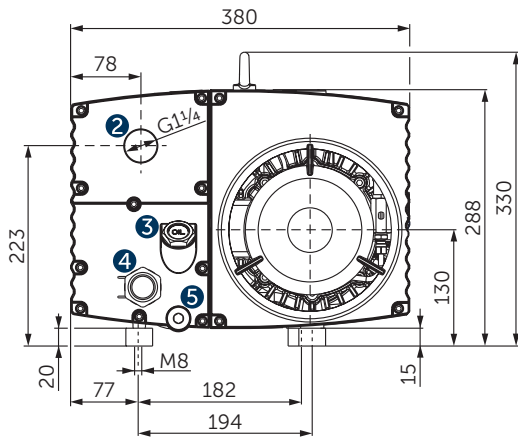

- 1 Vacuum connection (G1¼)
- 2 Exhaust air connection (G1¼)
- 3 Oil filler cap (G¾)
- 4 Oil sight glass (G1)
- 5 Screw plug for oil drain (G½)
- 6 Rubber buffer position
- L Overall device length L1 with motor. L1 and M1 are variable, see separate motor specification sheet.
- Including gas ballast valve, non-return valve, oil separator and oil filter
- The motor illustration may vary
- Dimensions in mm

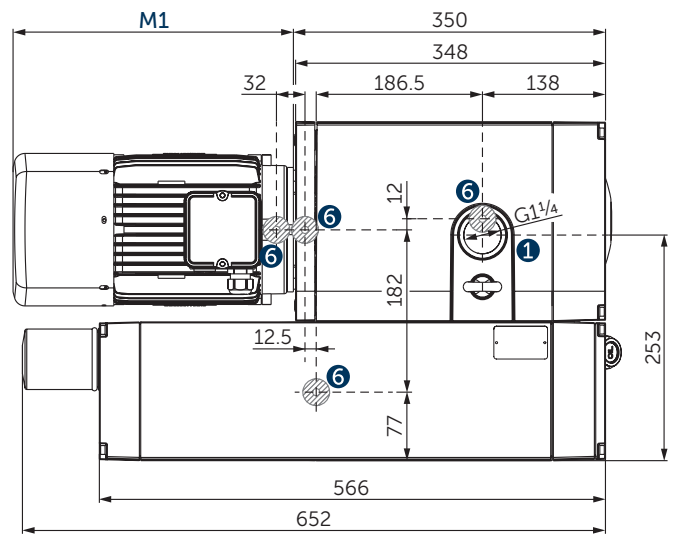

Nominal capacity		Vacuum absolute for continuous operation		Installed motor power		Emission sound pressure level ¹⁾		Weight incl. motor	Oil ²⁾
m ³ /h		mbar		kW		dB(A)		kg	l
50 Hz	60 Hz	50 Hz	60 Hz	50 Hz	60 Hz	50 Hz	60 Hz		
70	84	<0.5–400	<0.5–400	1.5	1.8	64	67	≈68.5	2 (≈3.8 kg)

¹⁾ According to DIN EN ISO 11203, accuracy class of measurement: class 2, extended measurement uncertainty: 3 dB
1 m distance, at medium load, both connection sides piped

²⁾ See operating instructions

▪ Reference data (atmosphere): 1000 mbar, 20°C; Tolerance: ±10%

▪ Gas ballast valve: water vapour tolerance max. 7 mbar; water vapour capacity max. 0.3 l/h (at 85°C operating temperature)

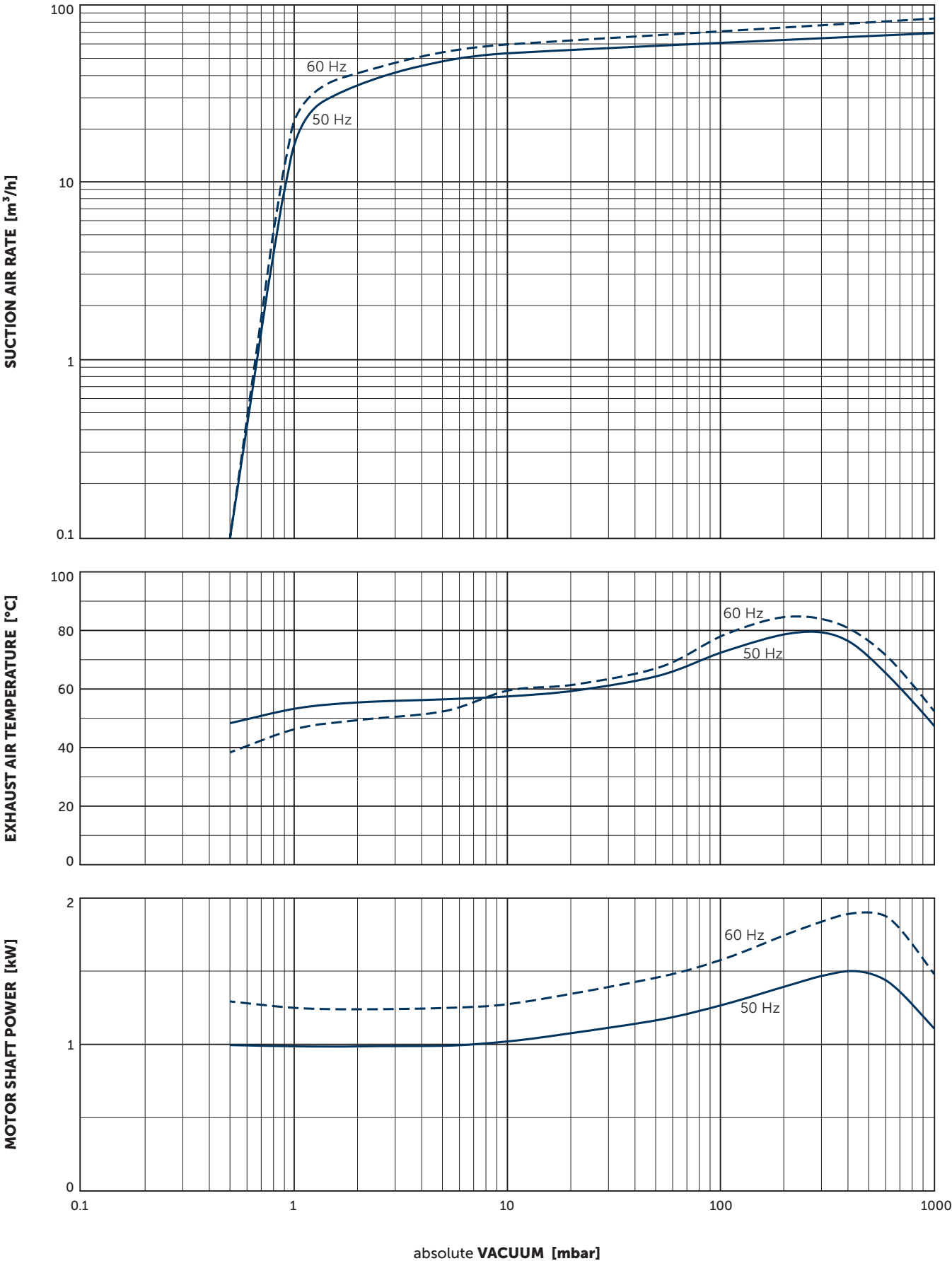

Suction air rate refers to the intake pressure
Reference data (atmosphere): 1000 mbar, 20°C
Tolerance: ±10%

MAKE IT BECKER.

HOMEPAGE
U 5. O2-PACK



DOWNLOAD
MOTOR SPECS.



ONLINE SHOP

